

# Supplemental Information for 296-381 or GTG101X Thermostat Housing Gasket MGA, MGB, Sprite/Midget 948, 1098, 1275, Classic Mini

## Why make a new gasket ?

Moss Motors has been selling the same rubber-cork composite gasket (286-380) for as long as anyone can remember. It is virtually identical to the gasket fitted these MGs when they were in production. They work, but as customers push the boundary between restoration and high performance, we have been asked to provide high performance alternatives to the OEM gaskets. This gasket is the result of our ongoing program to develop truly superior gaskets using the best materials and modern gasket design practices.

## Who is Klinger and why should I care?

The Klinger Group has been making technically advanced gasket material since they opened their doors in 1866. Founded in Austria, the company now has manufacturing and distribution centers in 40 countries. They have taken the science of gasket design and engineering to a level that has earned them an excellent reputation. Because their green gasket material is now associated with a superior product, there are companies making green gaskets that look like Klingsil. but they don't work nearly as well. All Klinger material is clearly marked "KLINGERSIL".

## What is Klingsil ?

The specific Klingsil material selected for this gasket is made using an asbestos-free blend of aramid and other synthetic fibers with a nitrile binder. It will compress about 11%, and it will provide an excellent seal at high pressures (up to 750 lbs PSI) and high temperatures (up to 400 °F). It is resistant to oils, water, steam, gases, salt solutions, fuels, alcohols, organic and inorganic acids, hydrocarbons, lubricants and refrigerants.

## Who actually makes the gasket ?

Our engineers produced the cad drawings in-house along with the specifications. The gaskets are made for us here in the US by a company that has been designing and making specialty gaskets for over 25 years. The bottom line? This is the best gasket for this application at any price.

## What about the notch to clear the valve cover?

The 3 studs for the thermostat housing are asymmetrical. The gasket can go on only one way. Because we knew which section of the gasket would be next to the valve cover, we made that section (A) thinner. It will clear the valve cover - it is the same width as the original gasket in this area.



CAD Drawing

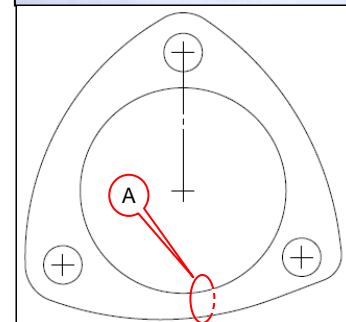
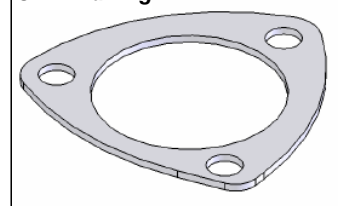

Comments? Questions? Please use the simple email form on the "Contact Us" page on the Moss website:

<http://www.mossmotors.com/AboutMoss/ContactUs.aspx>

If you prefer, you may call our Technical Services Department at 805-681-3411. So many people call us for help that we are often not able to answer the calls as fast as we'd like, and you may be asked to leave a message. We apologize in advance for the inconvenience. We will make every effort to get back to you within 2 business days.



### Moss Motors, Ltd.

440 Rutherford Street, Goleta, California 93117

In the US & Canada Toll Free (800) 667-7872 FAX (805) 692-2510 (805) 681-3400

### Moss Europe Ltd.

Hampton Farm Industrial Estate, Hampton Road West, Hanworth Middlesex, TW13 6DB

In the UK: 020-8867-2020 FAX:- 020-8867-2030

Instruction Sheet 296-381\_GTG101X March 2010, Revised July 2010